

# H090MH091L091SG

---

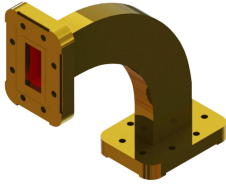

90° H Plane Swept Bend for WR90, 8.2–12.4 GHz, with interface types PDR100 and UDR100, 91 mm x 91 mm, gray

## Product Classification

**Product Type** Rectangular waveguide, swept bend

## General Specifications

**Component** 90° H Plane Swept Bend

**Interface** PDR100

**Interface 2** UDR100

## Dimensions

**Length** 91 mm | 3.583 in

**Length 2** 91 mm | 3.583 in

**Waveguide Size** WR90 | WG16 | R100

## Electrical Specifications

**Operating Frequency Band** 8.2 – 12.4 GHz

**VSWR** 1.05

## Material Specifications

**Finish** Gray

## Regulatory Compliance/Certifications

Agency	Classification
ISO 9001:2015	Designed, manufactured and/or distributed under this quality management system