

PANEL 3 RU

| REV. | MCO | DWN | DATE |
|------|-------------|------|-----------|
| C | 40027101MCO | LASR | 08-JAN-16 |
| D | 40032858MCO | SC | 19-AUG-16 |

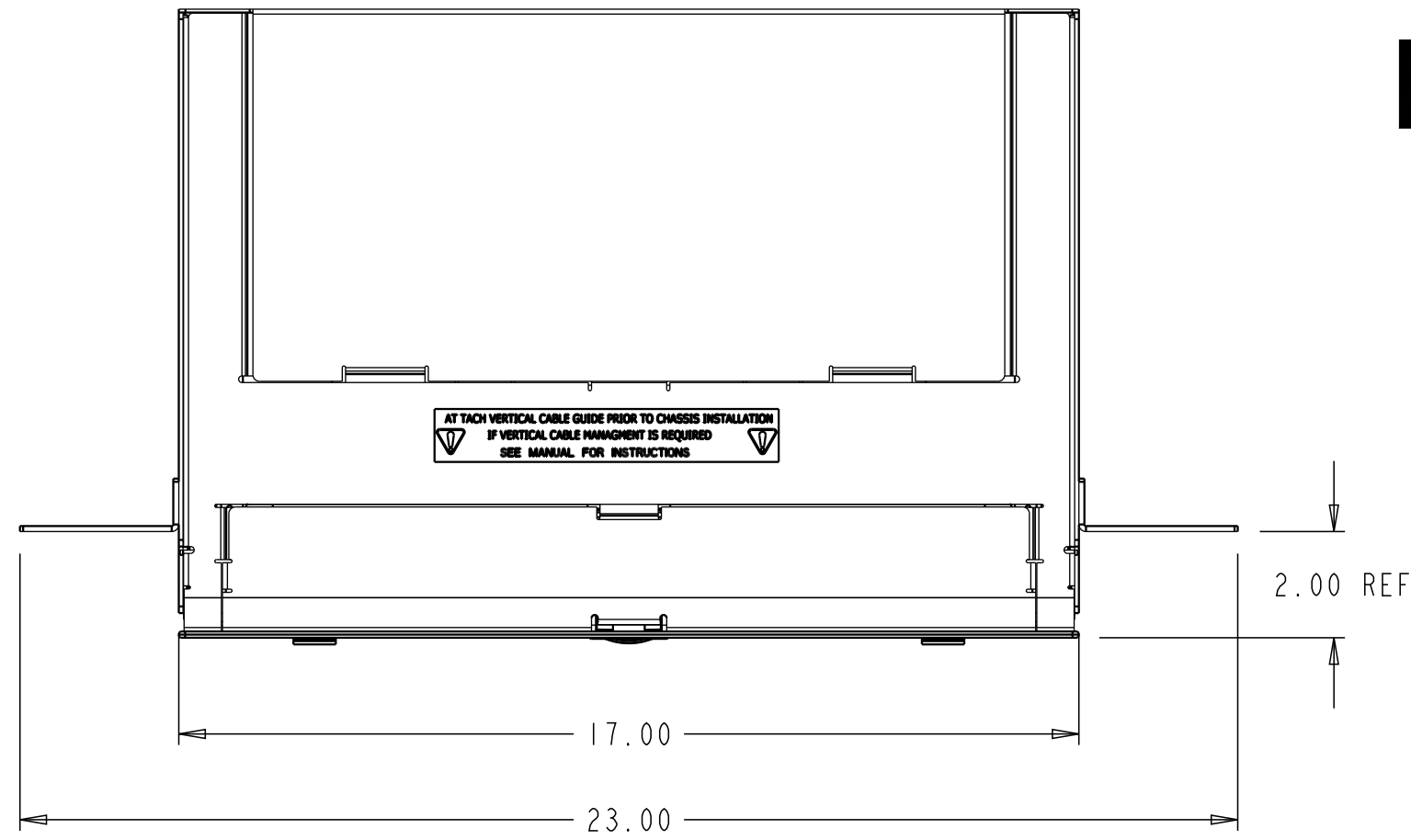

TOP VIEW

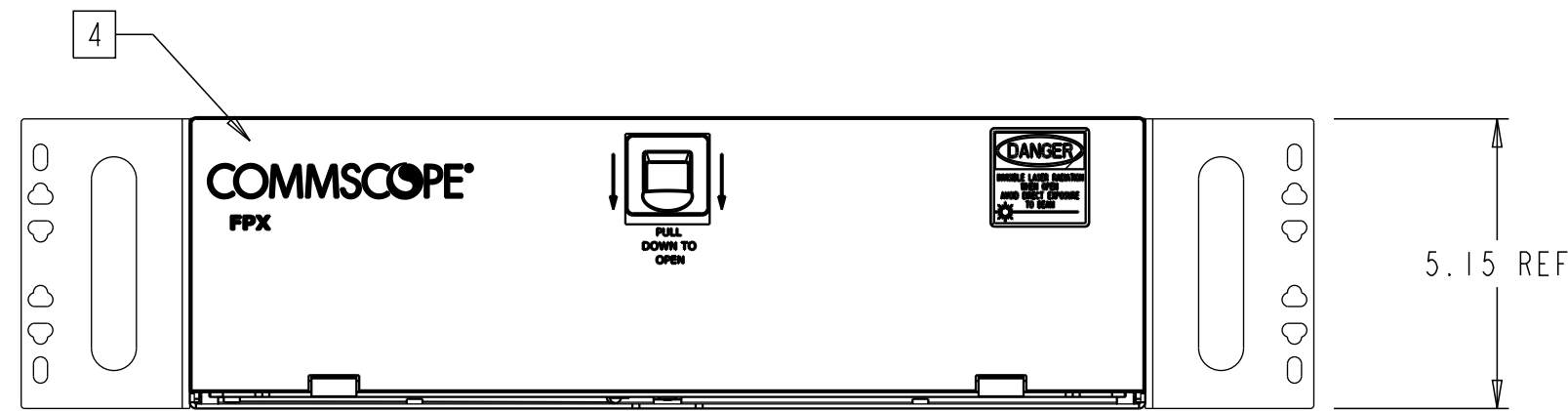

FRONT VIEW

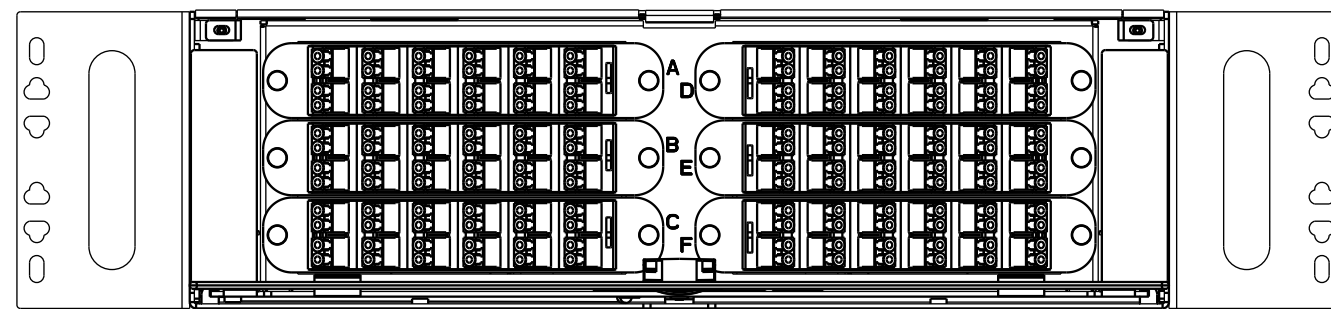

FRONT VIEW - 3RU WITH 23" MOUNTING BRACKETS
(144 POS ADAPTER PLATES SHOWN FOR REFERENCE)
SHOWN WITH FRONT DOOR REMOVED

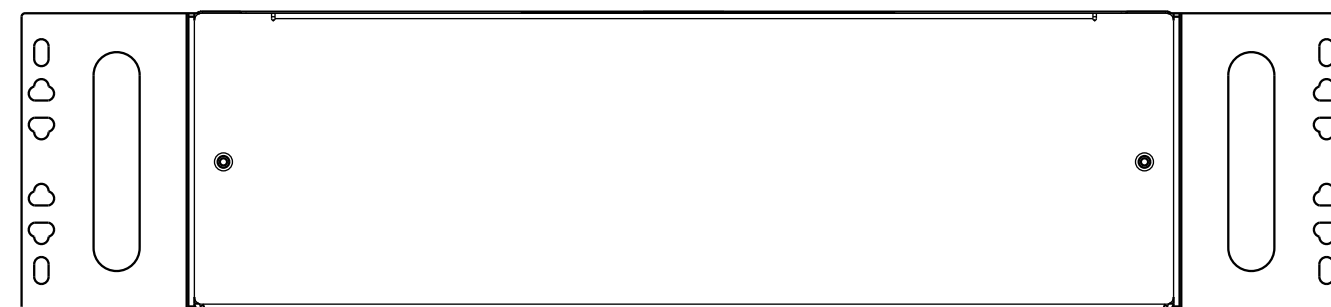

REAR VIEW

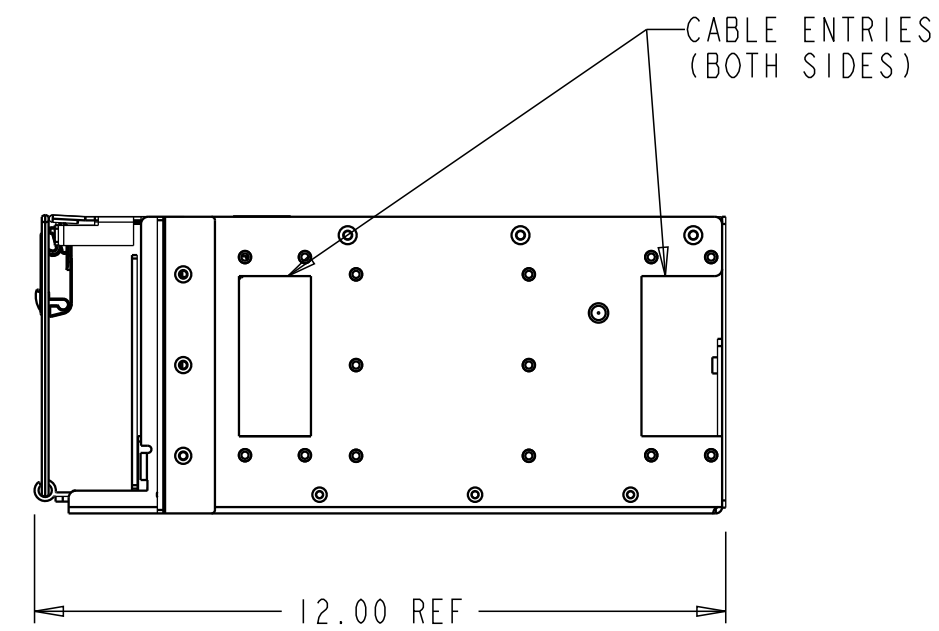
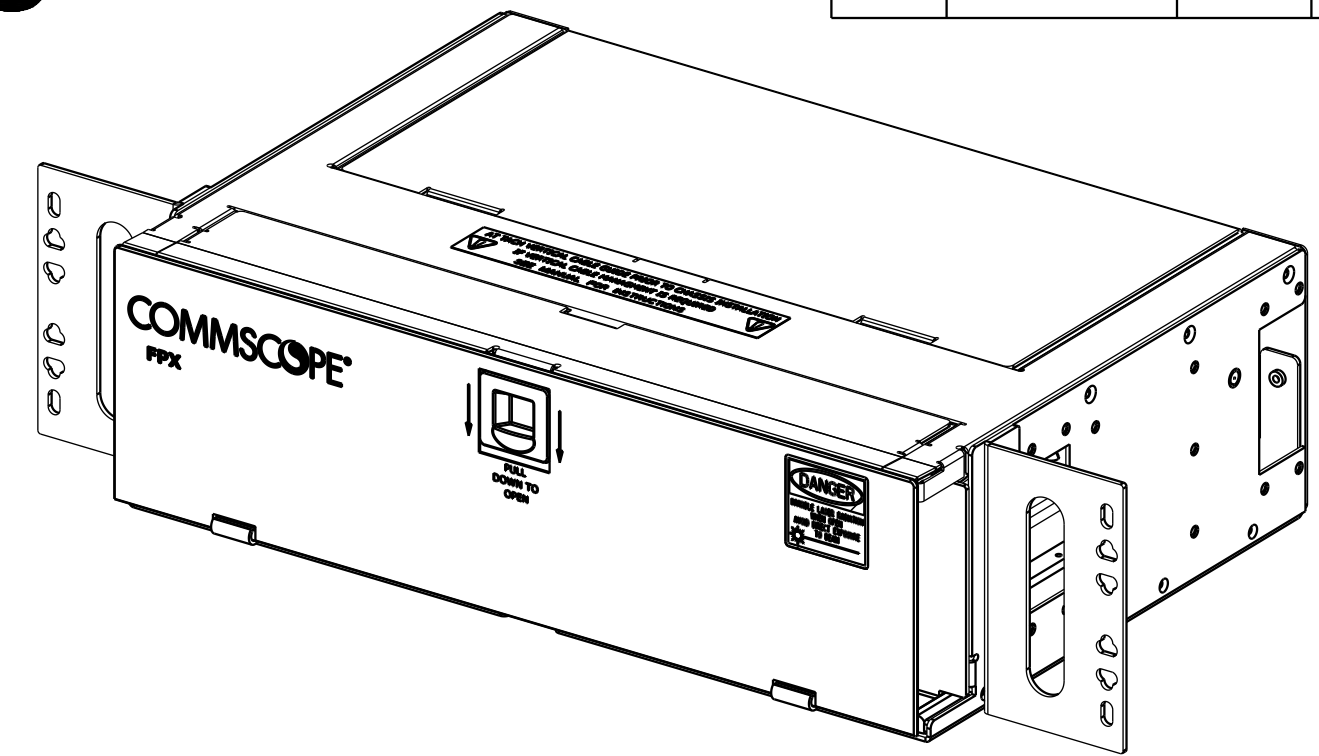

RIGHT VIEW

| SHIP ALONG ITEMS | | |
|------------------|----------------------|-----|
| ITEM | DESCRIPTION | QTY |
| 001 | CLAMP YOKE | 4 |
| 002 | GROMMET | 2 |
| 003 | GROMMET | 2 |
| 004 | GROMMET | 2 |
| 005 | GROMMET | 2 |
| 006 | CLAMP COVER | 2 |
| 007 | CLAMP SCREW | 4 |
| 008 | #12 SCREW | 4 |
| 009 | #12 WASHER | 8 |
| 010 | WASHER | 4 |
| 011 | 10-32 MACHINE SCREW | 2 |
| 012 | #12 GROUND WASHER | 2 |
| 013 | 6-32 SCREW | 8 |
| 014 | CLAMP YOKE | 2 |
| 015 | CABLE CLAMP COVER | 1 |
| 016 | SCREW 6-32X3/4 | 2 |
| 017 | CABLE CLAMP BRACKET | 1 |
| 018 | 6-32, .250 SCREW PAN | 2 |
| 019 | STANDOFF | 2 |
| 020 | WASHER FLAT 1/4 SS | 2 |
| 021 | N125-00 1/4-20 | 2 |
| 022 | GROUNDING TERMINAL | 2 |
| 023 | SPIRAL WRAP | 4FT |
| 024 | VCG | 2 |
| 025 | CABLE SHIELD | 2 |
| 026 | EDGE PROTECTOR | 10 |
| 027 | CABLE SHIELD BRACKET | 2 |
| 028 | 6-32, .250 SCREW | 4 |

NOTES:

- PANEL CAN BE MOUNTED AT 2", 5" OR 8" DEPTHS IN 19" OR 23" RACKS USING WECCO OR EIA PATTERNS.
- REMOVE VERTICAL CABLE GUIDE FOR 2" RECESS MOUNT.
- CABLE CLAMP IS INCLUDED WITH CHASSIS (0.4 - 0.7) O.D.
- POLYCARBONATE FRONT DOOR.
- VCG SYSTEM CAN ONLY BE INSTALLED WHEN THE MOUNTING BRACKETS ARE ON 5" OR 8" POSITIONS.
- BEFORE SLIDE OUT THE DRAWER, REMOVE SHIPPING SCREWS (2).

COMMSCOPE, INC.

| | | | |
|---|---|--|----------|
| © 2016 COMMSCOPE, INC. CONFIDENTIAL NOTICE: THESE DRAWINGS AND SPECIFICATIONS ARE THE PROPRIETARY PROPERTY OF COMMSCOPE, INC. AND MAY BE USED ONLY FOR THE SPECIFIC PURPOSE AUTHORIZED IN WRITING BY COMMSCOPE, INC. | | TITLE INSTALLATION DWG FPX, 3&4 RU 1FC AFA 12" DEPTH | |
| ALL DIMS AND TOLERANCES .XX:±N/A ARE INCHES UNLESS .XXX:±N/A OTHERWISE SPECIFIED ANGULAR:±N/A | C SIZE | DRAWING NUMBER 300100106859 | D REV |
| DO NOT SCALE DRAWING | ENGR: LUIS MIGUEL RENTERIA DWN: ASAHEL SALCEDO | SHT. 1 OF 4 | |

DIMENSIONS IN INCHES
THIRD ANGLE PROJECTION

PANEL 4 RU

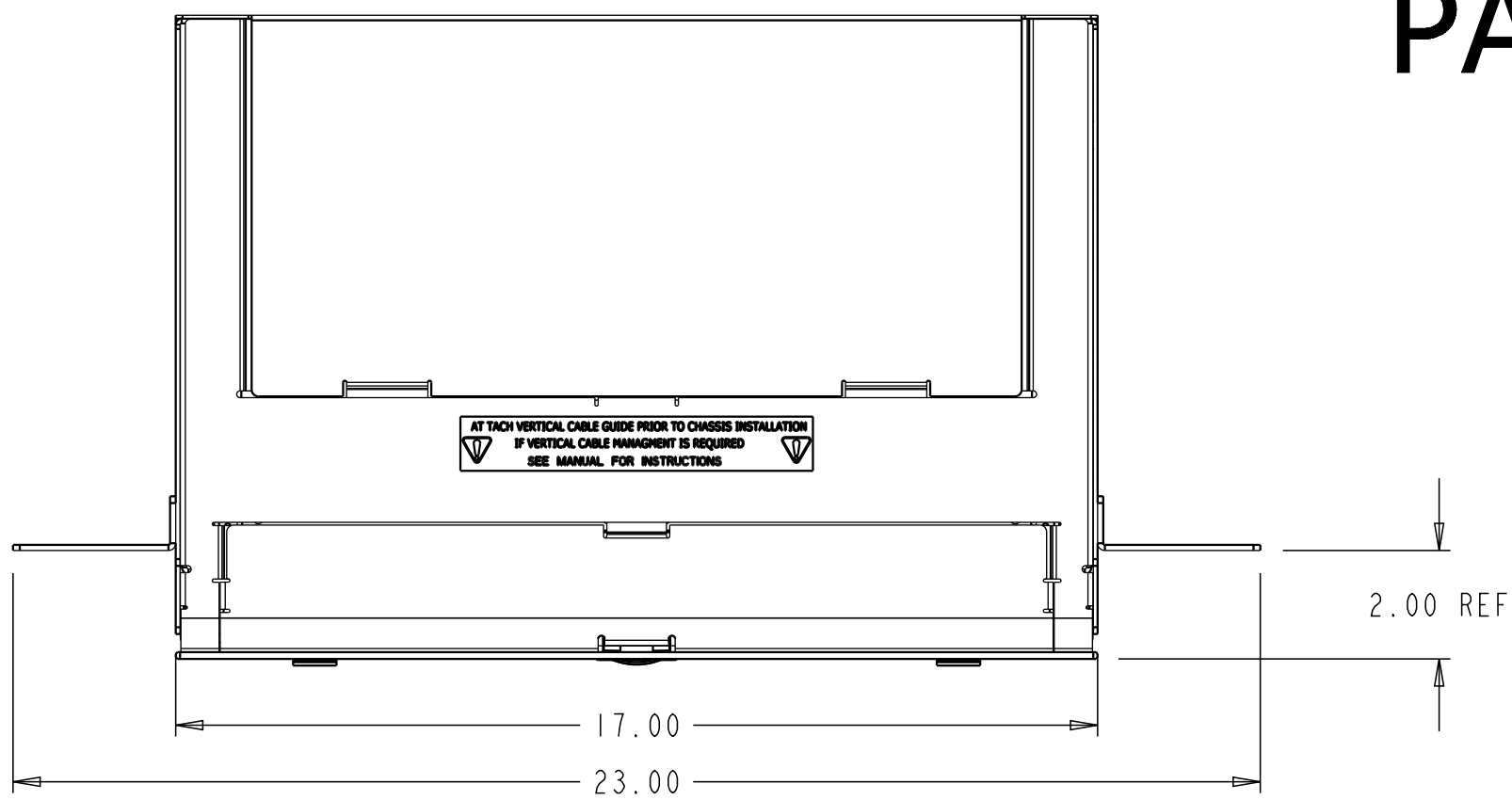

TOP VIEW

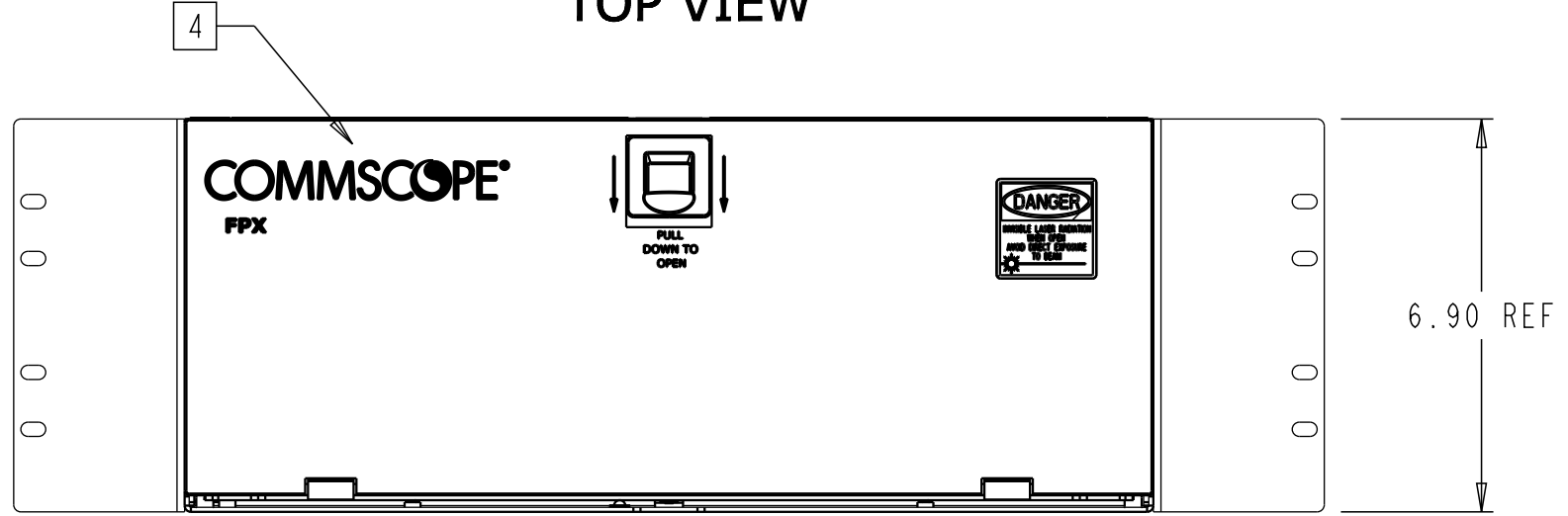

FRONT VIEW

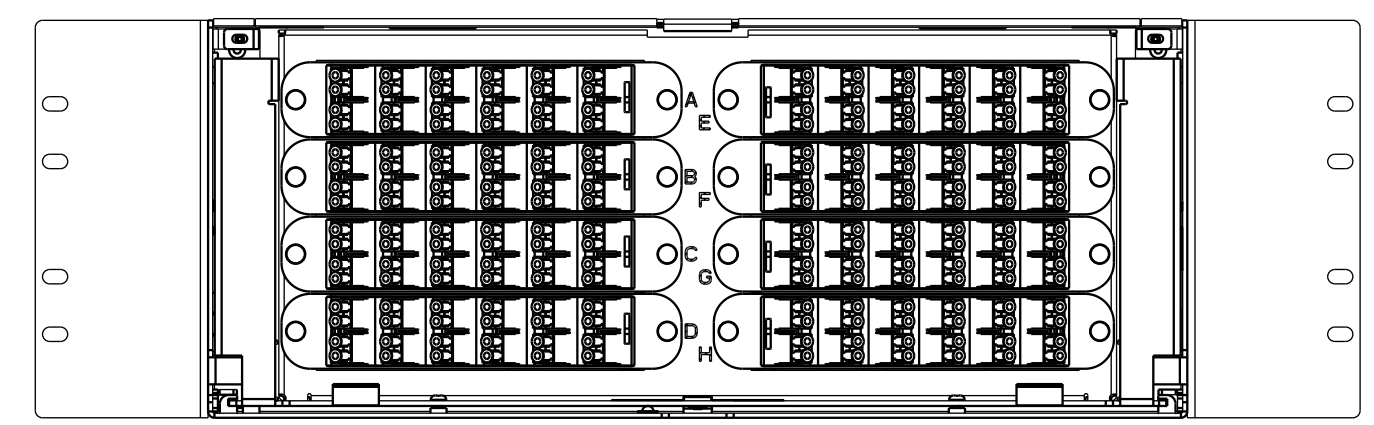

FRONT VIEW - 4RU WITH 23" MOUNTING BRACKETS
(192 POS ADAPTER PLATES SHOWN FOR REFERENCE)
SHOWN WITH FRONT DOOR REMOVED

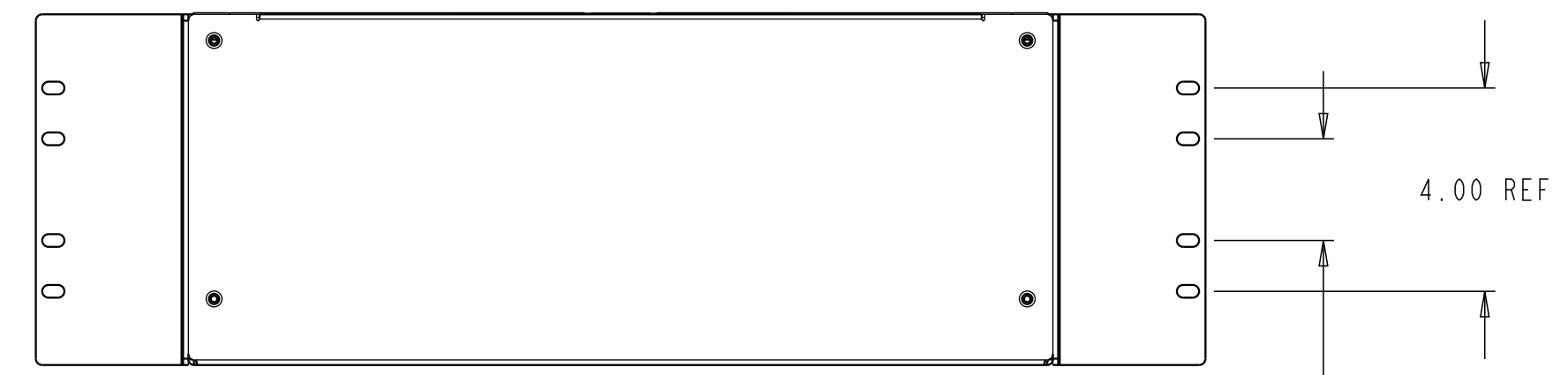

REAR VIEW

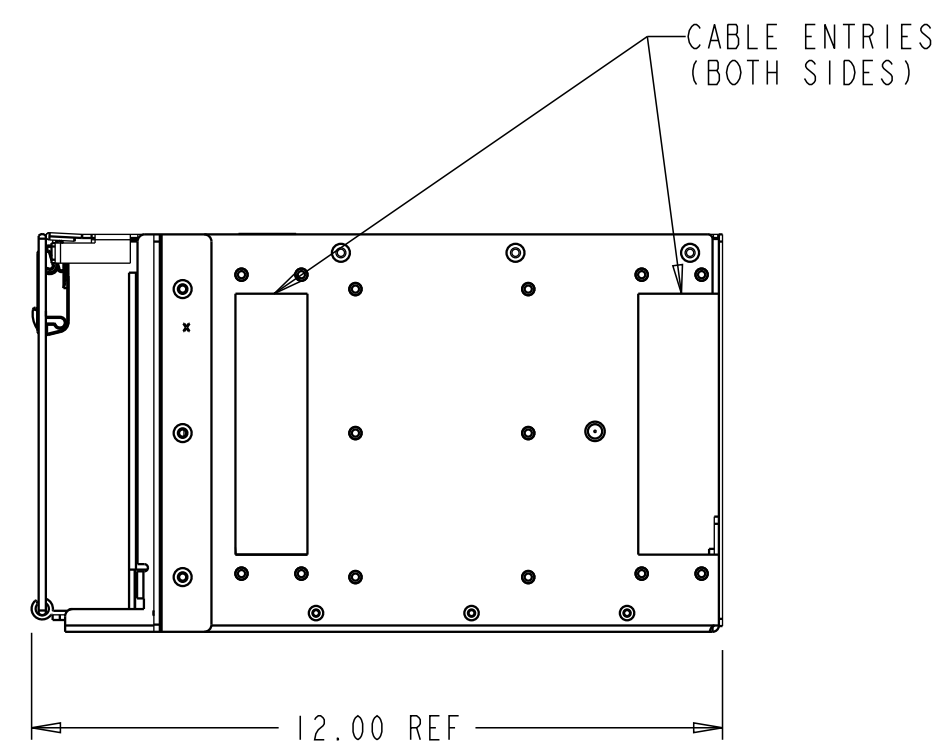

RIGHT VIEW

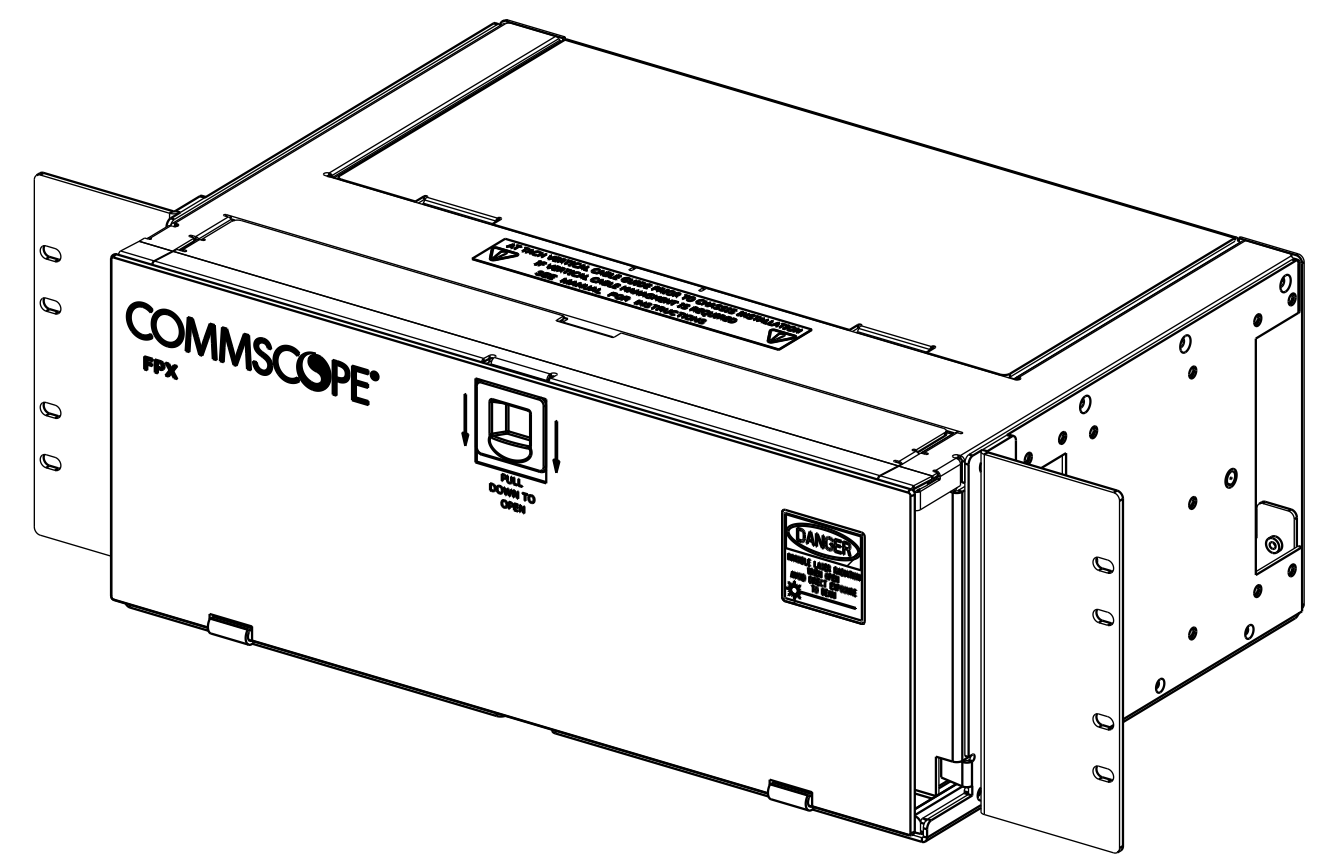

| SHIP ALONG ITEMS | | |
|------------------|----------------------|-----|
| ITEM | DESCRIPTION | QTY |
| 001 | CLAMP YOKE | 4 |
| 002 | GROMMET | 2 |
| 003 | GROMMET | 2 |
| 004 | GROMMET | 2 |
| 005 | GROMMET | 2 |
| 006 | CLAMP COVER | 2 |
| 007 | CLAMP SCREW | 4 |
| 008 | #12 SCREW | 4 |
| 009 | #12 WASHER | 8 |
| 010 | WASHER | 4 |
| 011 | 10-32 MACHINE SCREW | 2 |
| 012 | #12 GROUND WASHER | 2 |
| 013 | 6-32 SCREW | 8 |
| 014 | CLAMP YOKE | 2 |
| 015 | CABLE CLAMP COVER | 1 |
| 016 | SCREW 6-32X3/4 | 2 |
| 017 | CABLE CLAMP BRACKET | 1 |
| 018 | 6-32, .250 SCREW PAN | 2 |
| 019 | STANDOFF | 2 |
| 020 | WASHER FLAT 1/4 SS | 2 |
| 021 | N125-00 1/4-20 | 2 |
| 022 | GROUNDING TERMINAL | 2 |
| 023 | SPIRAL WRAP | 4FT |
| 024 | VCG | 2 |
| 025 | CABLE SHIELD | 2 |
| 026 | EDGE PROTECTOR | 12 |
| 027 | CABLE SHIELD BRACKET | 2 |
| 028 | 6-32, .250 SCREW | 6 |
| 029 | 6-32, 1.375, SCREW | 2 |

© 2016 COMMSCOPE, INC. CONFIDENTIAL
NOTICE: THESE DRAWINGS AND SPECIFICATIONS ARE THE PROPRIETARY PROPERTY OF COMMSCOPE, INC. AND MAY BE USED ONLY FOR THE SPECIFIC PURPOSE AUTHORIZED IN WRITING BY COMMSCOPE, INC.

ALL DIMS AND TOLERANCES .XX:±N/A ARE INCHES UNLESS .XXX:±N/A OTHERWISE SPECIFIED ANGULAR:±N/A

DO NOT SCALE DRAWING

ENGR: LUIS MIGUEL RENTERIA
DWN: ASAHEL SALCEDO

TITLE: INSTALLATION DWG FPX, 3&4 RU 1FC AFA 12" DEPTH

DRAWING NUMBER: 300100106859

SHT. 2 OF 4

COMMSCOPE, INC.

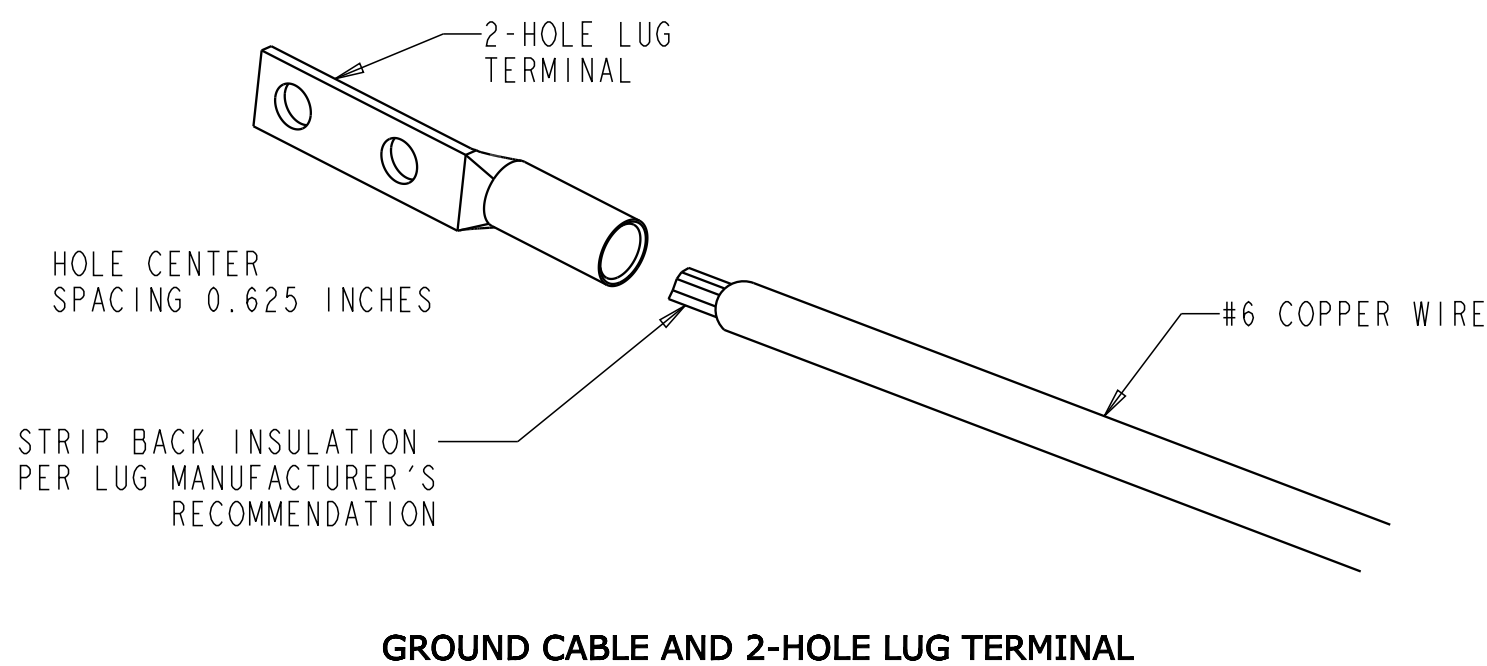
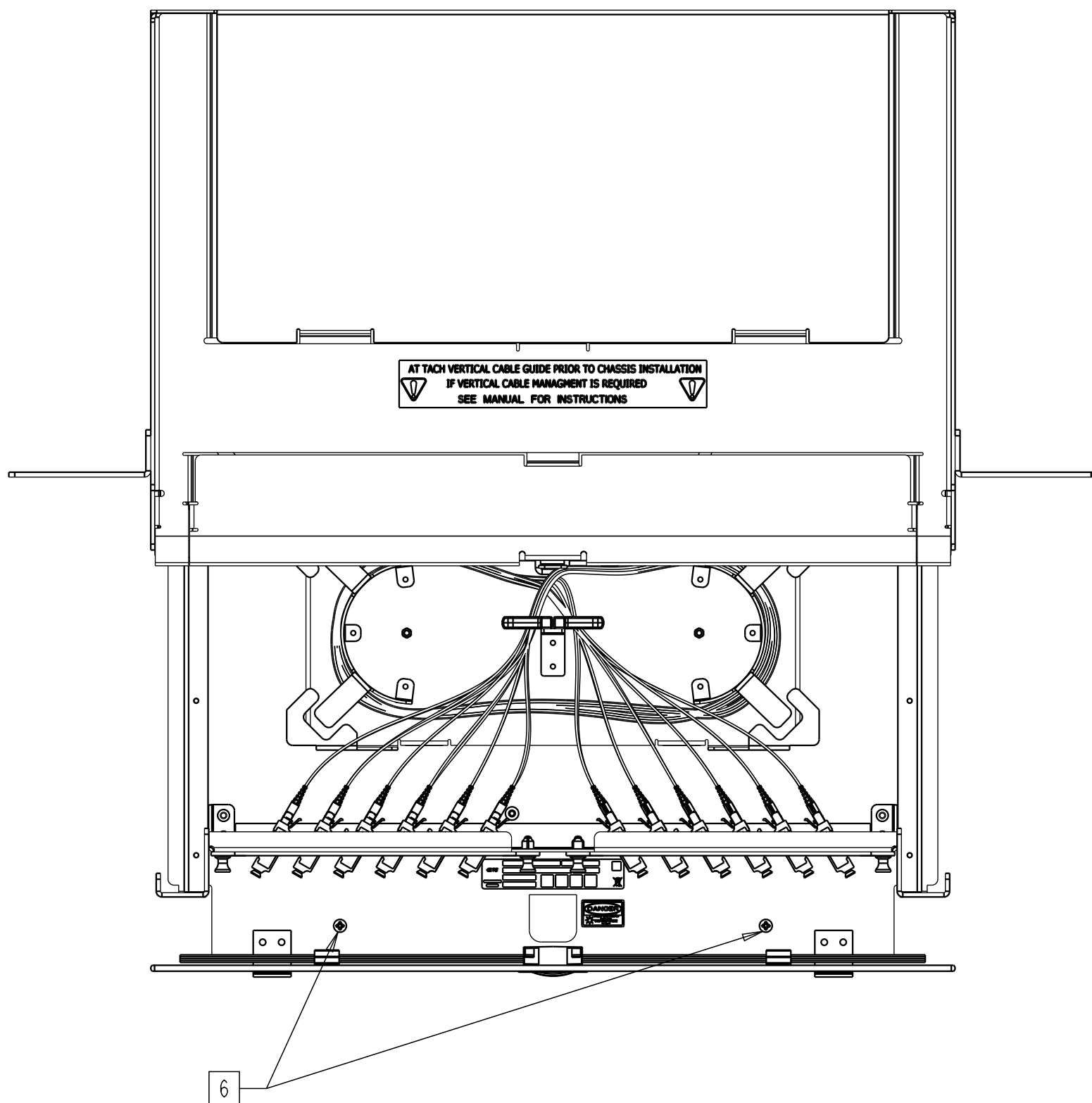

PANEL GROUNDING

EACH PANEL HAS A GROUNDING LOCATION MARKED WITH THE STANDARD GROUNDING SYMBOL. THIS LOCATION IS ON THE RIGHT SIDE OF THE PANEL AS SHOWN IN FPX 3&4 RU PANEL DIAGRAM. USE THE TWO #10-32 GROUND SCREWS (ITEM 011) AND TWO #10 STAR WASHERS (ITEM 012) PROVIDED TO CONNECT A #6 COPPER GROUNDING CABLE TO THE PANEL. GROUND THE UNIT TO THE LOCAL FACILITY GROUND BUS PER LOCAL PRACTICE. A TWO-HOLE GROUNDING LUG IS SHOWN IN FIGURE FOR REFERENCE.

ALL PANEL IS BUILDING WITH SCREWS THREAD-FORMING WITH NIBS IN ORDER TO CUT THE PAINT AND GROUND ALL WALLS OF PANEL.

NOTES:

1. GROUND THE UNIT TO THE LOCAL FACILITY CBN (COMMON BONDING NETWORK) OR IBN (ISOLATED BONDING NETWORK) PER LOCAL PRACTICE.
2. GROUND SCREWS ARE TO BE TORQUED AT 40 IN-LIB
3. THE FIBER PANEL NEXT GENERATION IS DESIGNED TO BE INSTALLED IN AN ENVIRONMENTALLY CONTROLLED NETWORK TELECOMMUNICATIONS FACILITY SUCH AS A CENTRAL OFFICE, CONTROLLED ENVIRONMENTAL VAULT, OR DATA CENTER.

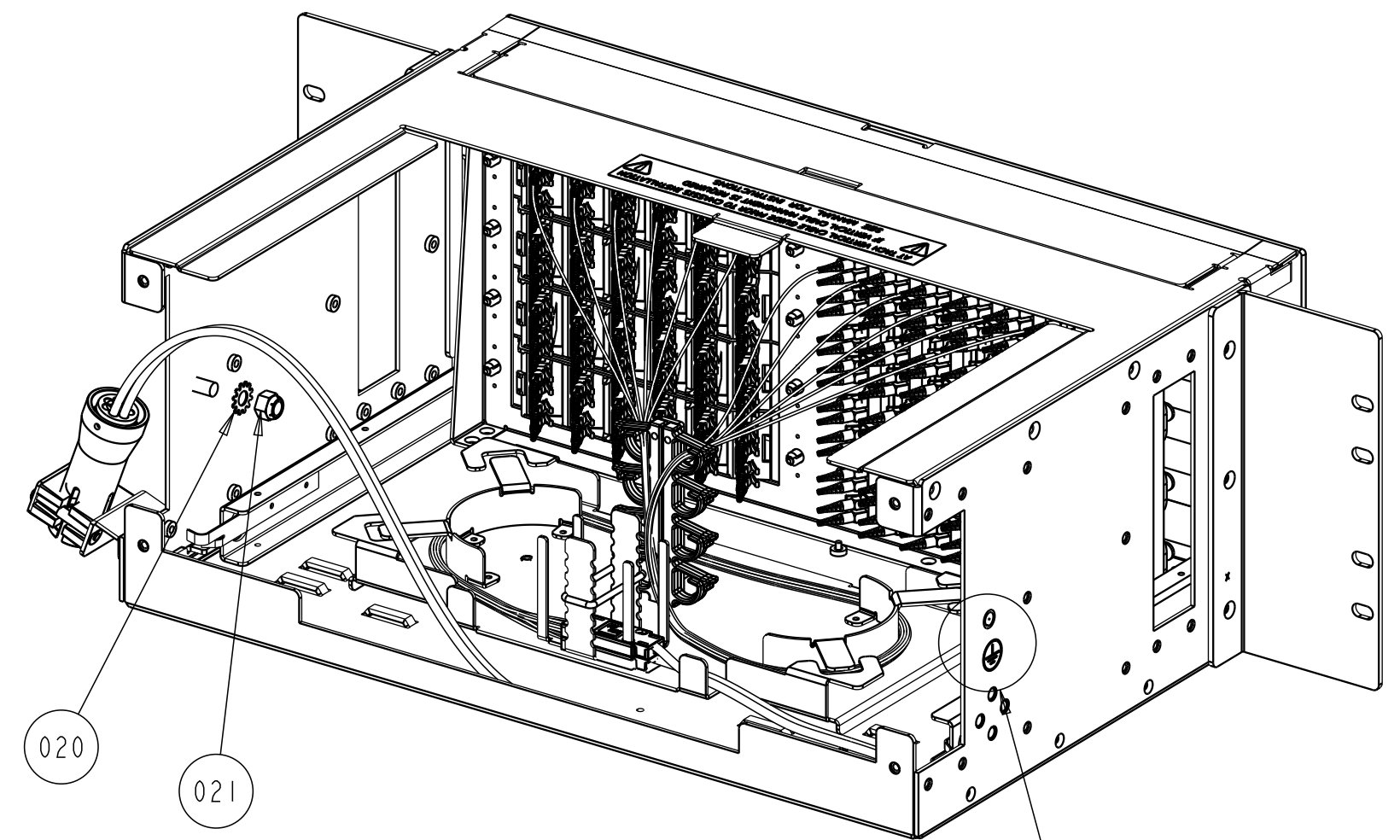

ISO REAR VIEW
SHOWN WITH REAR DOOR REMOVED
(PANEL 4RU FOR REFERENCE)

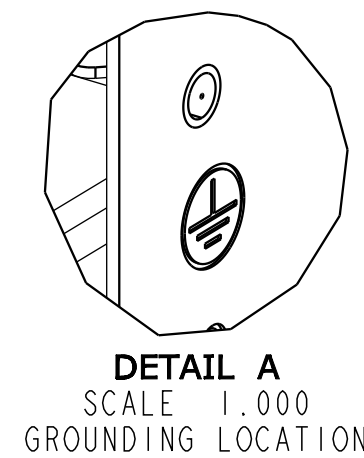

COMMSCOPE, INC.

| | | | |
|---|---|--|--------------------------------|
| © 2016 COMMSCOPE, INC. CONFIDENTIAL NOTICE: THESE DRAWINGS AND SPECIFICATIONS ARE THE PROPRIETARY PROPERTY OF COMMSCOPE, INC. AND MAY BE USED ONLY FOR THE SPECIFIC PURPOSE AUTHORIZED IN WRITING BY COMMSCOPE, INC. | | TITLE INSTALLATION DWG FPX, 3&4 RU IFC AFA 12" DEPTH | |
| ALL DIMS AND TOLERANCES ARE INCHES UNLESS OTHERWISE SPECIFIED | .XX:±N/A .XXX:±N/A ANGULAR:±N/A | C SIZE | DRAWING NUMBER 300100106859 |
| DO NOT SCALE DRAWING | ENGR: LUIS MIGUEL RENTERIA DWN: ASAHEL SALCEDO | SHT. 3 OF 4 | |

DIMENSIONS IN INCHES
THIRD ANGLE PROJECTION

SEE DETAIL B

USING PANEL FROM 4RU FOR REFERENCE

SEE DETAIL C

SEE DETAIL D

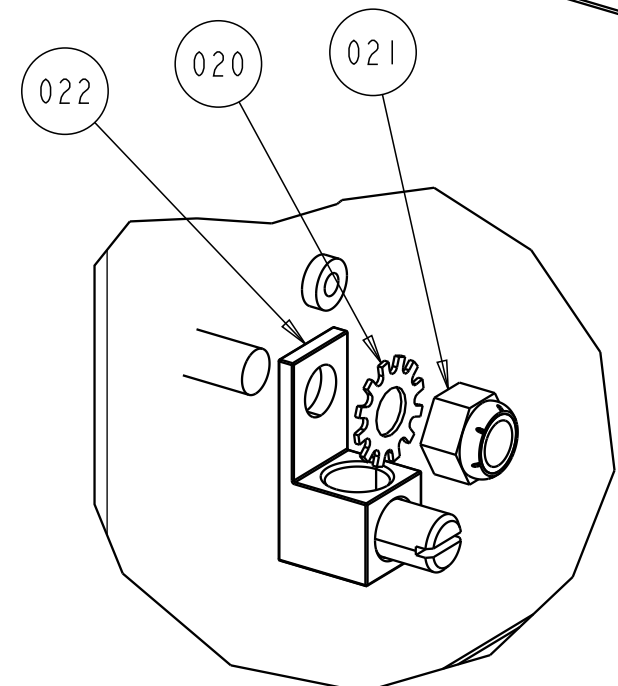

DETAIL B
SCALE 1.000

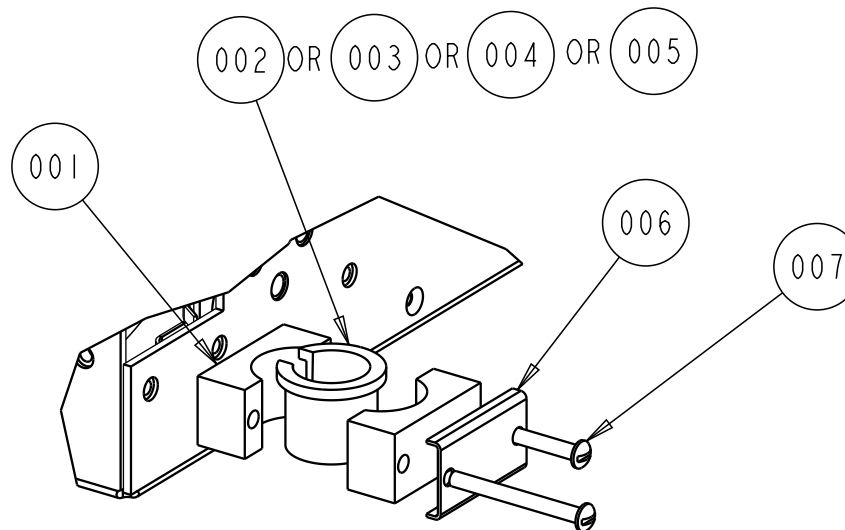

DETAIL D
SCALE 0.600

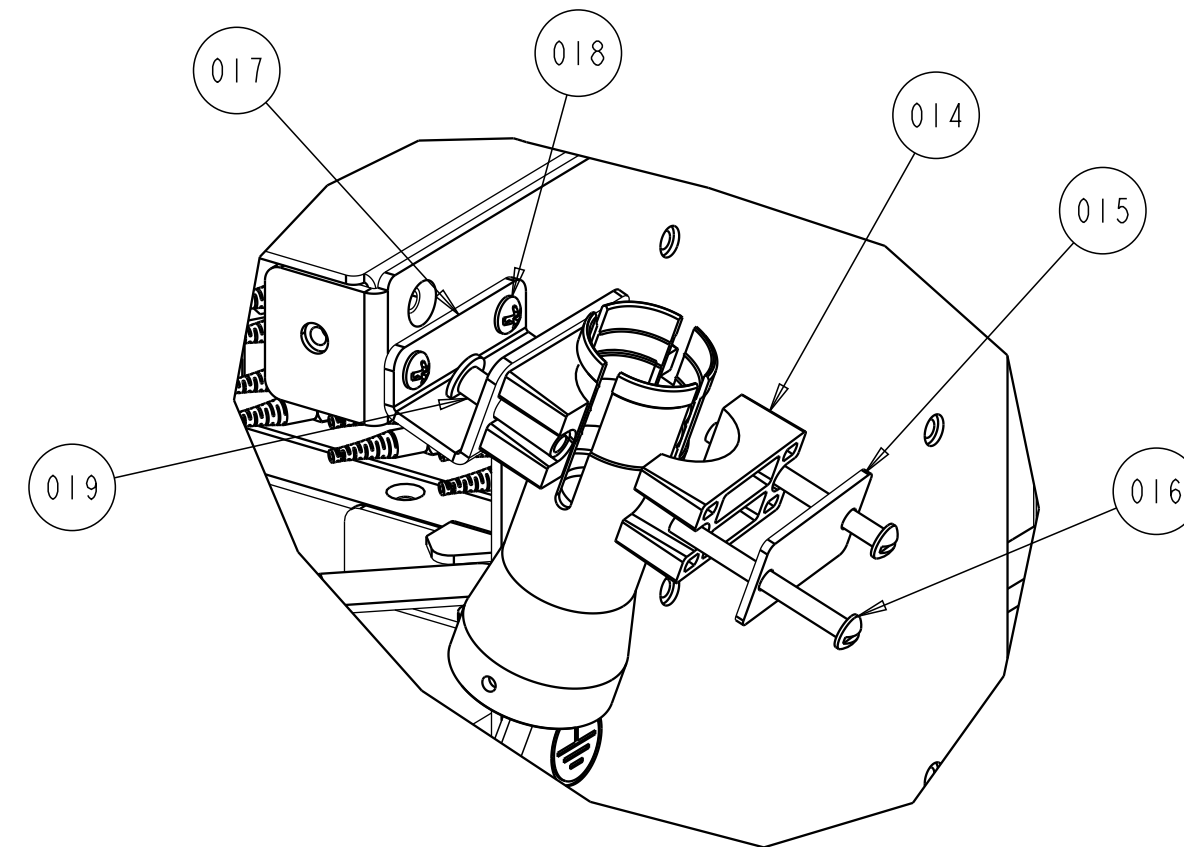

DETAIL C
SCALE 0.800

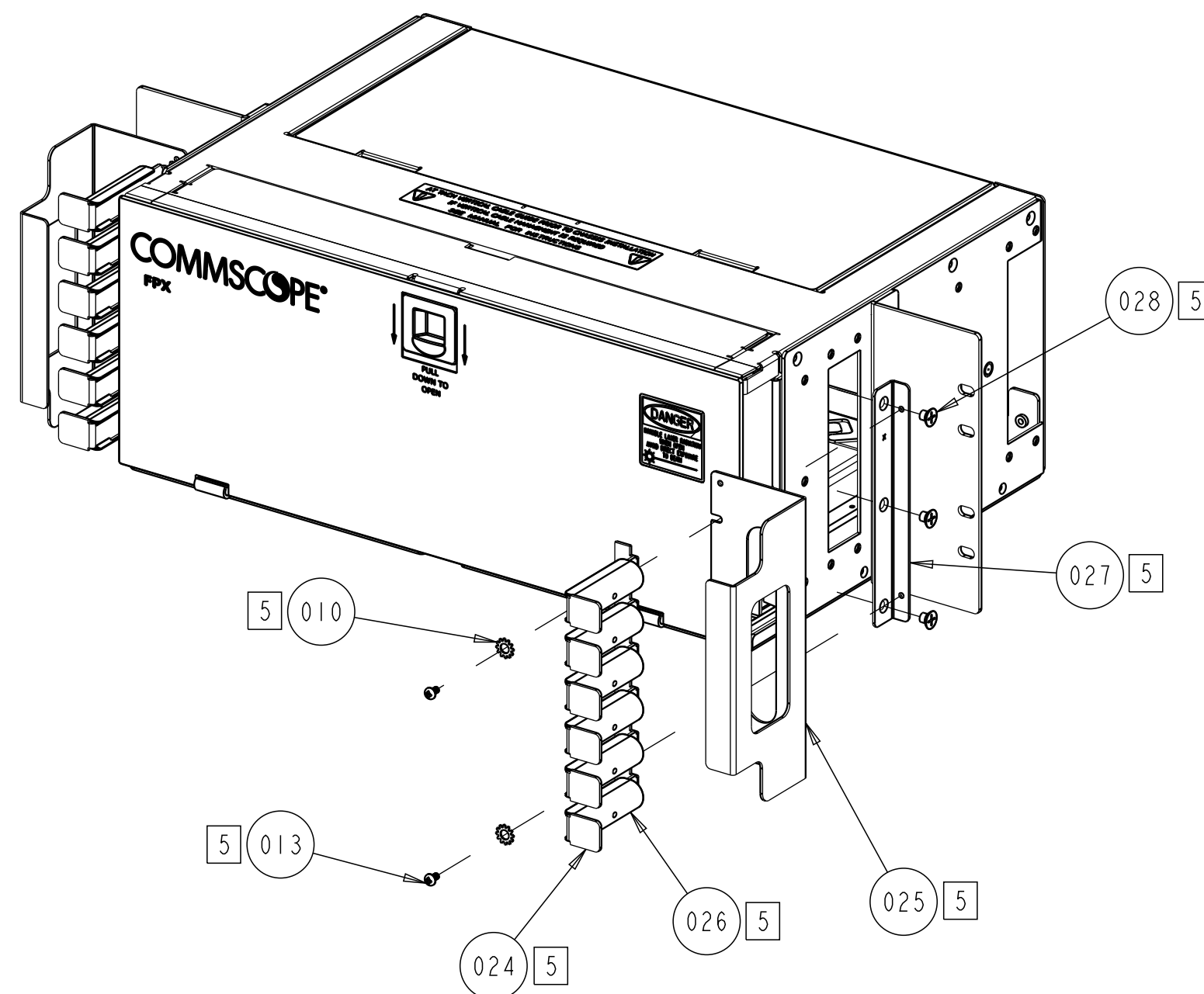
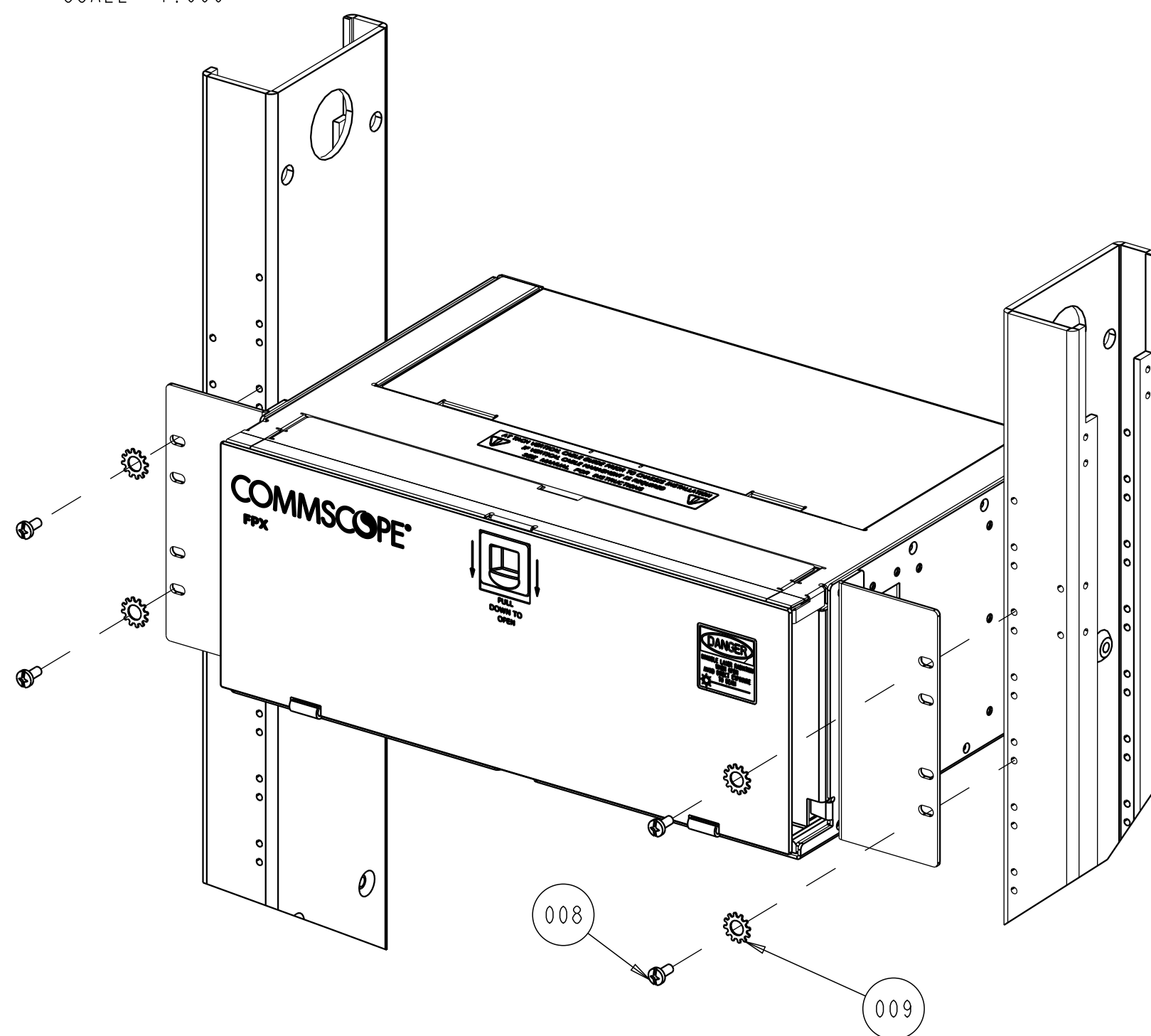

COMMSCOPE, INC.

| | | | |
|--|--|--|--------------------------------|
| <small>© 2016 COMMSCOPE, INC. CONFIDENTIAL NOTICE: THESE DRAWINGS AND SPECIFICATIONS ARE THE PROPRIETARY PROPERTY OF COMMSCOPE, INC. AND MAY BE USED ONLY FOR THE SPECIFIC PURPOSE AUTHORIZED IN WRITING BY COMMSCOPE, INC.</small> | | TITLE INSTALLATION DWG FPX, 3&4 RU IFC AFA 12" DEPTH | |
| <small>ALL DIMS AND TOLERANCES ARE INCHES UNLESS OTHERWISE SPECIFIED</small> | <small>.XX:±N/A .XXX:±N/A ANGULAR:±N/A</small> | C SIZE | DRAWING NUMBER 300100106859 |
| DO NOT SCALE DRAWING | | ENGR: LUIS MIGUEL RENTERIA DWN: ASAHIEL SALCEDO | SHT. 4 OF 4 |

DIMENSIONS IN INCHES
THIRD ANGLE PROJECTION