



ION®-B Series Low Power Remote Unit for EGSM 900, EGSM 1800, and UMTS

**OBSOLETE**

## Product Classification

**Product Type** Remote unit

**Product Brand** ION®-B

## General Specifications

**Note** Detailed Product Specifications are available. Please contact your local CommScope representative.

**Power Type** Low

## Dimension Drawing

# TFAN91/18/21-34

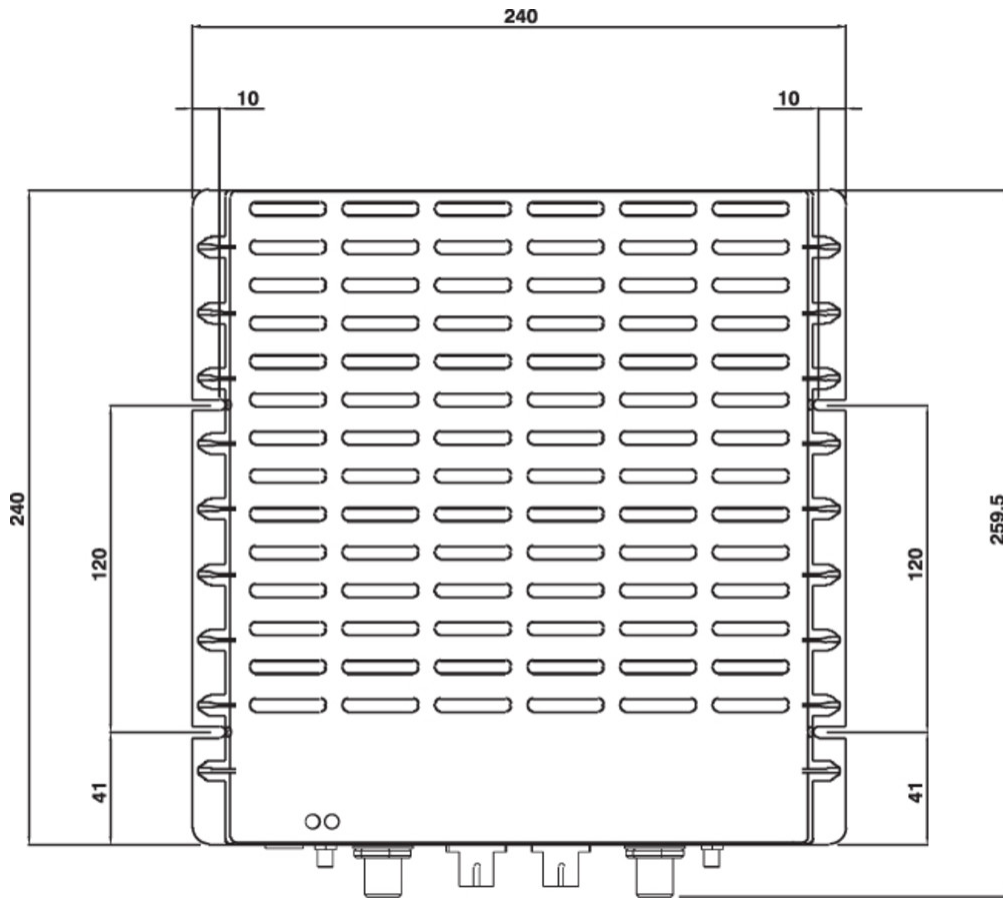

## Electrical Specifications

<b>Impedance</b>	50 ohm
<b>License Band</b>	EGSM 900   GSM 1800   UMTS
<b>Voltage Range</b>	-60 to -36 Vdc

## Electrical Specifications, Rx (Uplink)

<b>Operating Frequency Band</b>	1710 – 1785 MHz (GSM 1800)   1920 – 1980 MHz (UMTS)   880 – 915 MHz (EGSM 900)
---------------------------------	--

## Electrical Specifications, Tx (Downlink)

<b>Operating Frequency Band</b>	1805 – 1880 MHz (DCS 1800)   2110 – 2170 MHz (UMTS)   925 – 960 MHz (CEL 900)
---------------------------------	---

## Regulatory Compliance/Certifications

Agency	Classification
--------	----------------

# TFAN91/18/21-34

---

CHINA-ROHS	Below maximum concentration value
ISO 9001:2015	Designed, manufactured and/or distributed under this quality management system
REACH-SVHC	Compliant as per SVHC revision on <a href="http://www.commscope.com/ProductCompliance">www.commscope.com/ProductCompliance</a>
ROHS	Compliant



## Included Products

- TPSN3/05-30 – Power Supply Adapter ION®-B Series Remote Units, 30 W

# TPSN3/05-30

## Power Supply Adapter ION®-B Series Remote Units, 30 W



### Product Classification

<b>Product Type</b>	Power adapters
<b>Product Brand</b>	ION®-B

### General Specifications

<b>Note</b>	Detailed Product Specifications are available. Please contact your local CommScope representative.
-------------	--

### Dimension Drawing

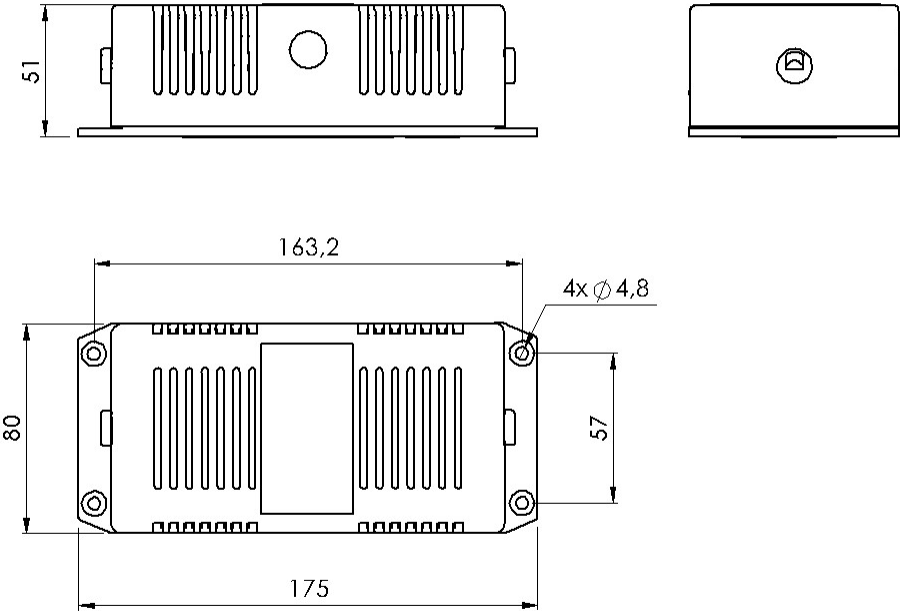

# TPSN3/05-30

---

## Electrical Specifications

**Output Power, maximum**

30 W

## Regulatory Compliance/Certifications

### Agency

### Classification

CHINA-ROHS

Below maximum concentration value

ISO 9001:2015

Designed, manufactured and/or distributed under this quality management system

REACH-SVHC

Compliant as per SVHC revision on [www.commscope.com/ProductCompliance](http://www.commscope.com/ProductCompliance)

ROHS

Compliant

