

4

3

2

1

1.0 GENERAL NOTES

- 1.1 ALL METRIC DIMENSIONS ARE IN BRACKETS [X. X]
- 1.2 FOR PATENT INFO: <https://www.cs-pat.com>

2.0 DESIGN NOTES

- 2.1 THIS KIT PROVIDES ADDITIONAL CLEARANCE BETWEEN RING MOUNT WELDMENTS (SUPPLIED SEPARATELY) AT THE PERIMETER OF THE MOUNTING POLE.

3.0 MANUFACTURING/SPECIAL REQUIREMENTS

- 3.1 INSTALL ALL RING MOUNT SECTIONS TO BE LEVEL AND EQUALLY SPACED
- 3.2 TIGHTEN ALL BOLTS SECURING FLAT PLATES BY THE TURN-OF-NUT METHOD. TIGHTEN ALL NUTS SECURING THREADED RODS TO A SNUG TIGHT CONDITION, WITH ATTENTION TO LEAVE EQUAL DISTANCE AND EQUAL FORCE ON EACH LEG OF THE THREADED ROD. SNUG TIGHT IS DEFINED AS THE CONDITION OBTAINED WITH A FEW IMPACTS OF AN IMPACT WRENCH OR THE FULL EFFORT OF AN IRONWORKER USING AN ORDINARY SPUD WRENCH

4.0 TEST

5.0 PACKAGING

- 5.1 PACKAGING SHALL MEET COMMSCOPE REQUIREMENTS PER DOCUMENT IS-PL-3005
- 5.2 PRINTED DOCUMENT TO BE PLACED INSIDE POLYBAG AND THEN IN SHIPPING CONTAINER
- 5.3 EXTRA HARDWARE MAY BE SUPPLIED, BAGGED AND SHIPPED

REVISIONS			
REV.	DESCRIPTION	DATE	APPROVED
A	INITIAL RELEASE	YX1027 21AUG24	AG1119 40201197CMO

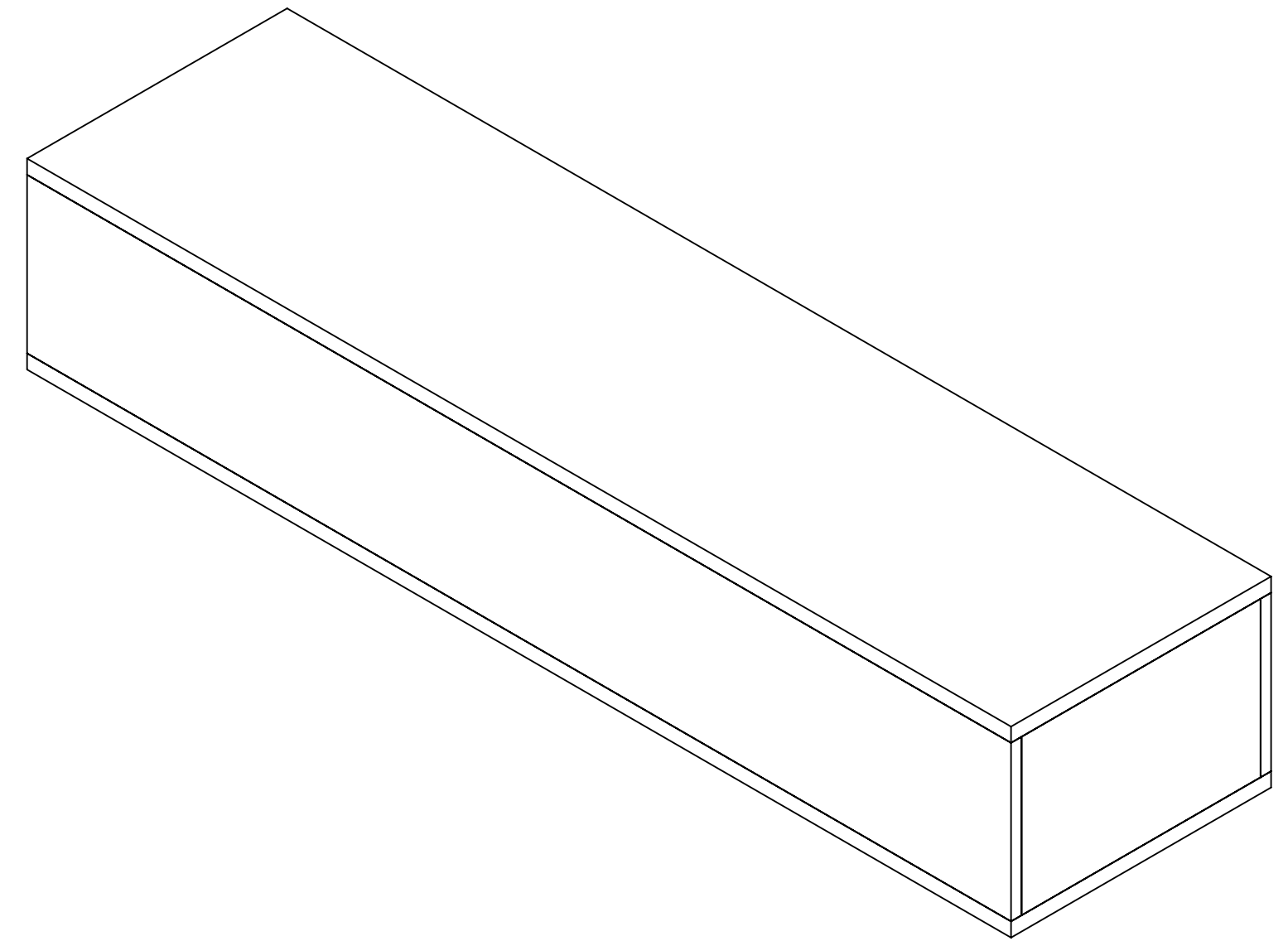
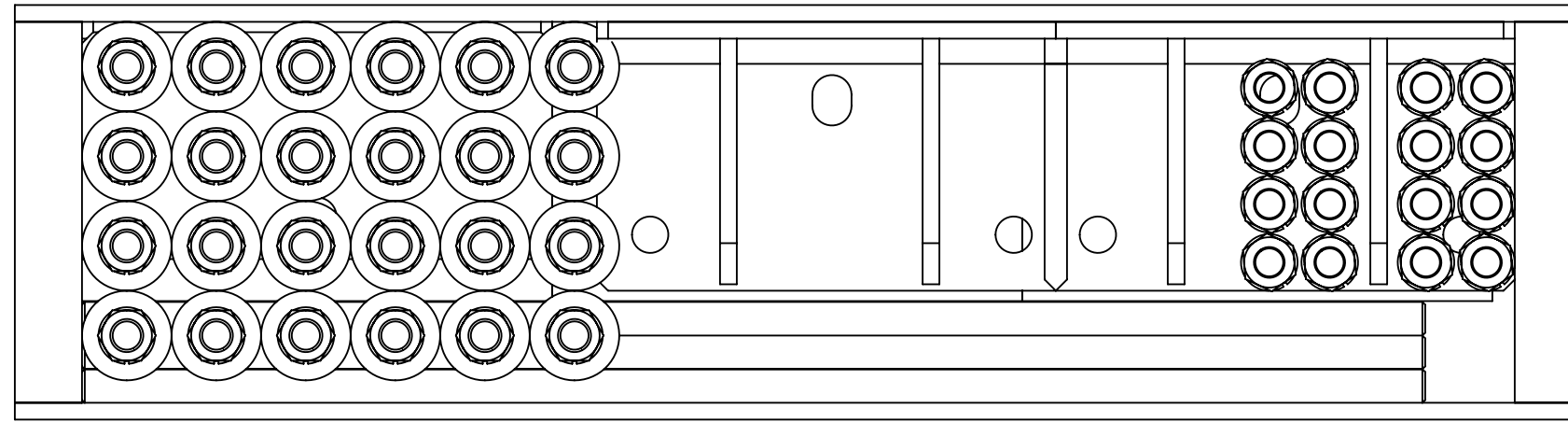

<b>COMMSCOPE, INC. OF NORTH CAROLINA</b>										
TOLERANCES					SAP MATERIAL MASTER					
1 PLACE .X[X] ± 0.2[6.3]			3 PLACE .XXX[X] ± 0.060[1.5]		<b>MC-RM-EXT</b>					
2 PLACE .XX[X] ± 0.12[3.0]			ANGLES ± 2°							
FINISH					MATERIAL					
<b>EXT PLATE KIT, RING MOUNT</b>										
UNLESS OTHERWISE SPECIFIED DIMENSIONS ARE IN INCHES INTERPRET PER ANSI Y 14.5M-1994	CE	YX1027	21AUG24	SCALE <b>1:4</b> DOCUMENT NO. <b>MC-RM-EXT</b>						
	RW	AG1119	09/04/2024							
	AD	YX1027	09/04/2024							
	RE	YMENG	09/04/2024							
	ECN 40201197CMO									
SIZE		Auth Group	INSL	MODEL			DRAWING			SHEET 1 OF 3
C			VERSION	STATUS	REVISION	VERSION	STATUS	REVISION		
			00	RE	A	00	RE	A		

DENSITY		lbs/in³
MASS	136.14	lbs
VOLUME	1064.97	in³
SURFACE AREA	5408.38	in²
HEIGHT	10.5"	
LENGTH	49.5"	
WIDTH	43.6"	

4

3

2

1

4

3

2

1

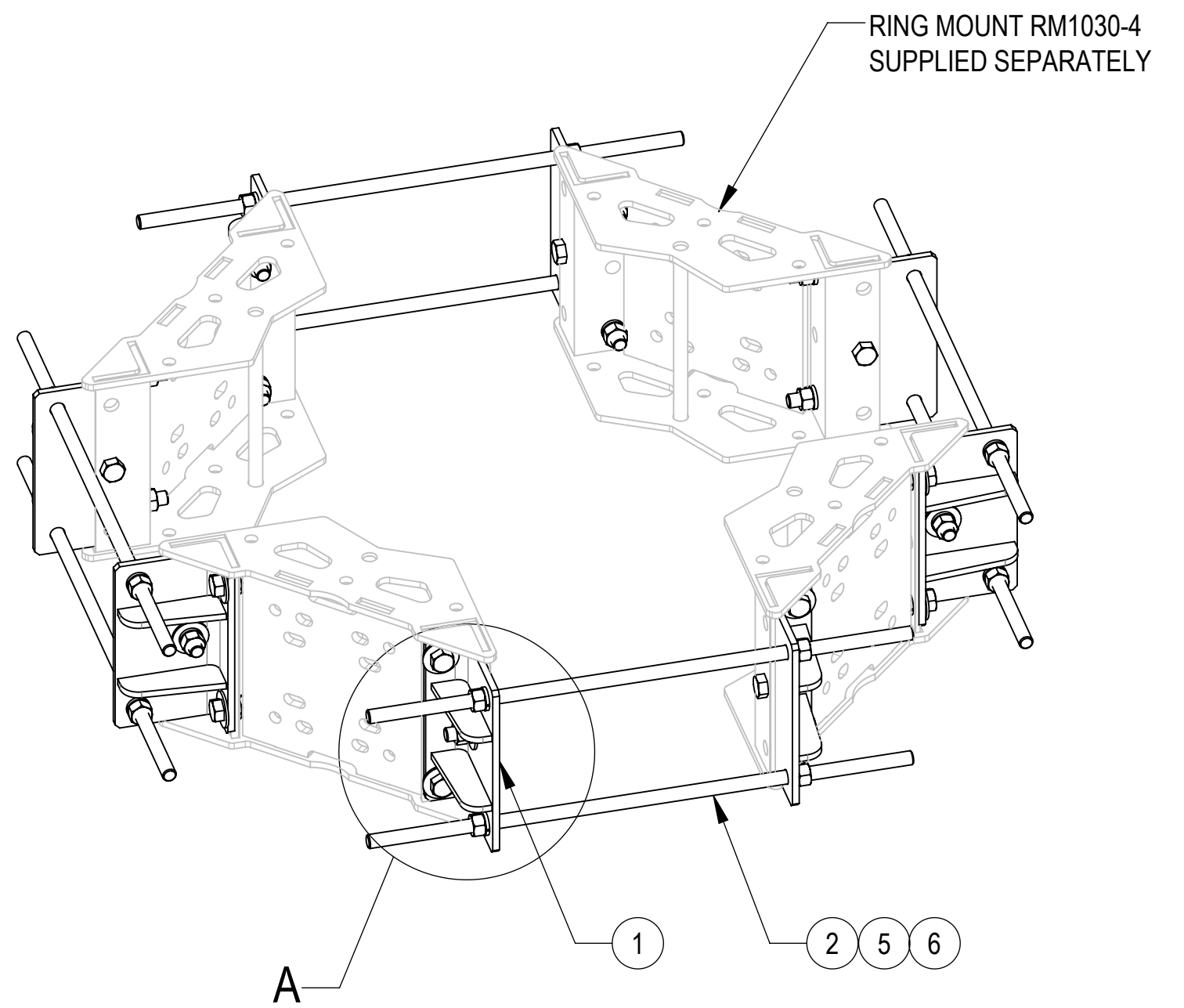
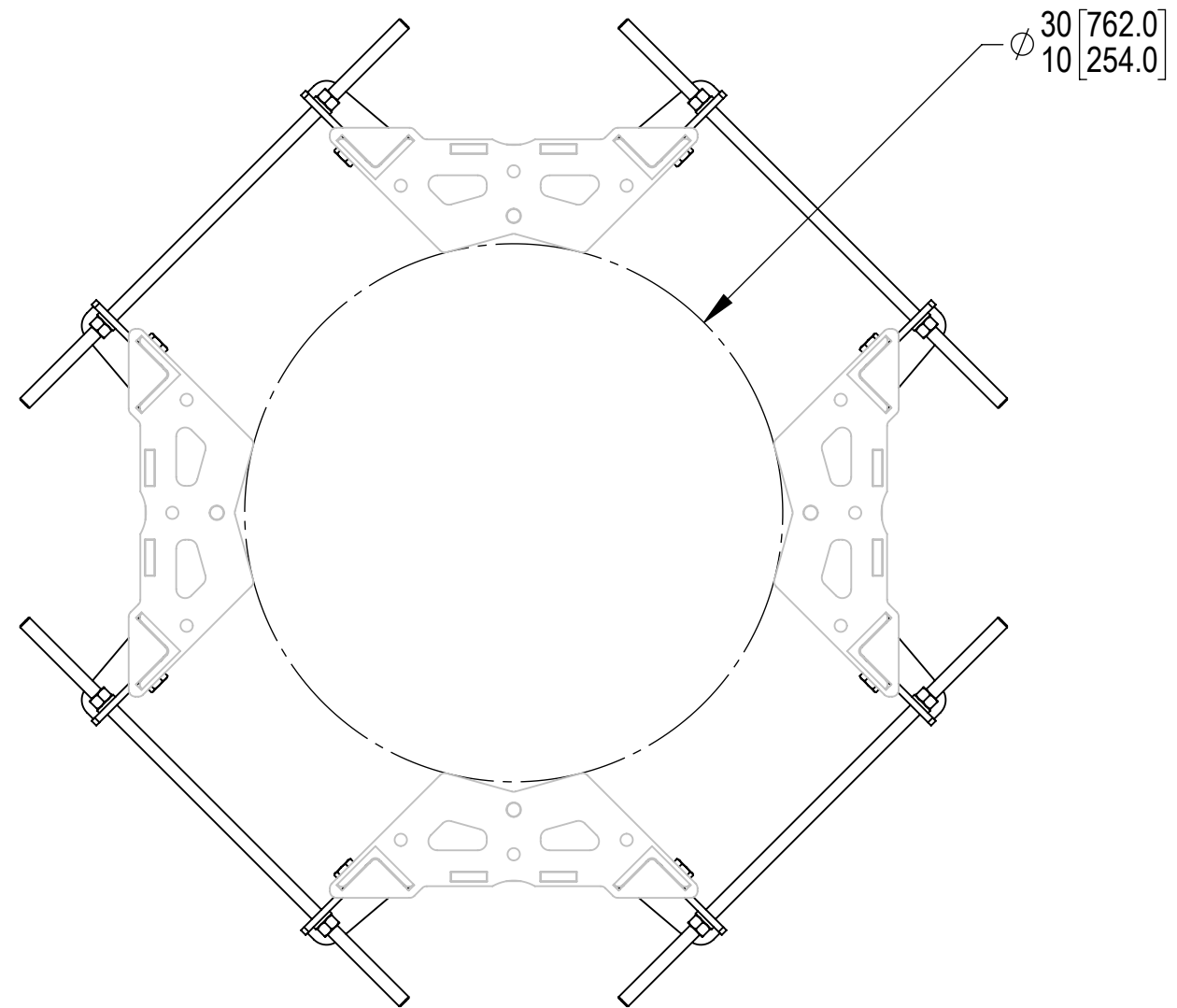

DO NOT REUSE OLD HARDWARE, NEW HARDWARE PROVIDED

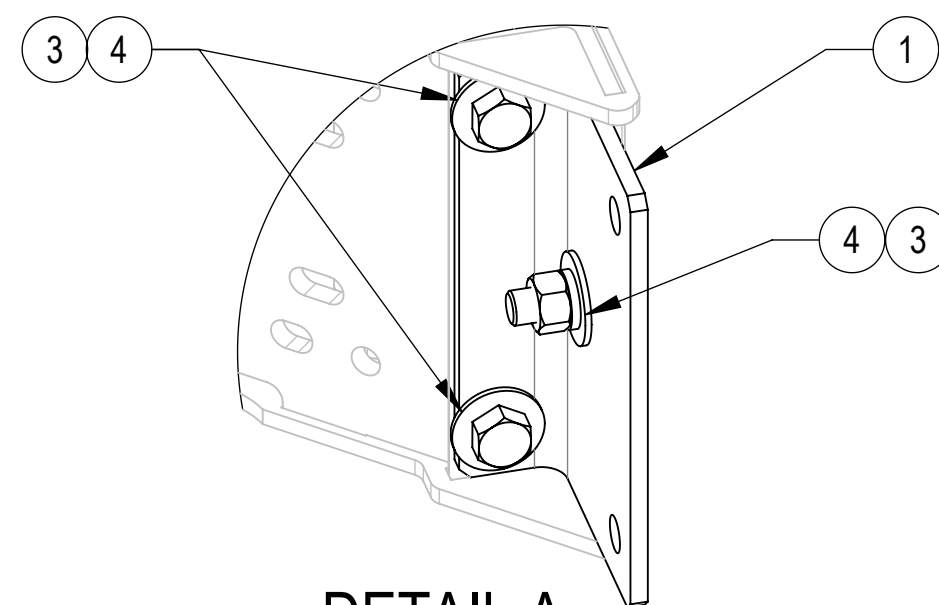
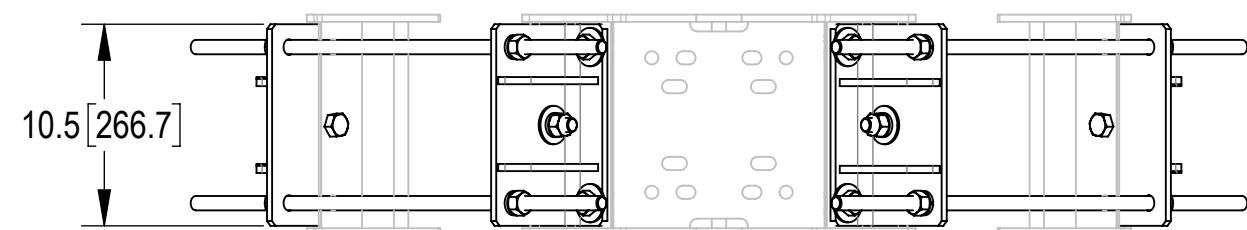

DETAIL A  
SCALE 1 : 4

COMPONENT PART NUMBERS PROVIDED FOR ASSEMBLY PURPOSES;  
INDIVIDUAL COMPONENTS MAY BE SHIPPED AS PARTS WITHIN AN INCLUDED KIT.

ITEM NO.	PART NUMBER	DESCRIPTION	QTY.	WEIGHT	NOTE NO.
1	RM1030320-00	WELDMENT, RING MOUNT EXTENSION	8	0.93 LBS	
2	MT38430B7	3/4" X 30" GALV THREADED ROD GRADE B7	8	3.73 LBS	
3	GB-0622A	3/4" X 2-1/4" GALV BOLT KIT (A325)	24	0.44 LBS	
4	GWF-06	3/4" GALV FLAT WASHER	24	0.10 LBS	
5	GWL-06	3/4" GALV LOCK WASHER	16	0.04 LBS	
6	GN-06	3/4" GALV HEX NUT	16	0.15 LBS	

COMMSCOPE, INC. OF NORTH CAROLINA					
TITLE EXT PLATE KIT, RING MOUNT					
SIZE C	SCALE 1:16	DOCUMENT NO. MC-RM-EXT			
		DRAWING			SHEET
		VERSION	STATUS	REVISION	2 OF 3
		00	RE	A	

4

3

2

1

D

D

C

C

B

B

A

A

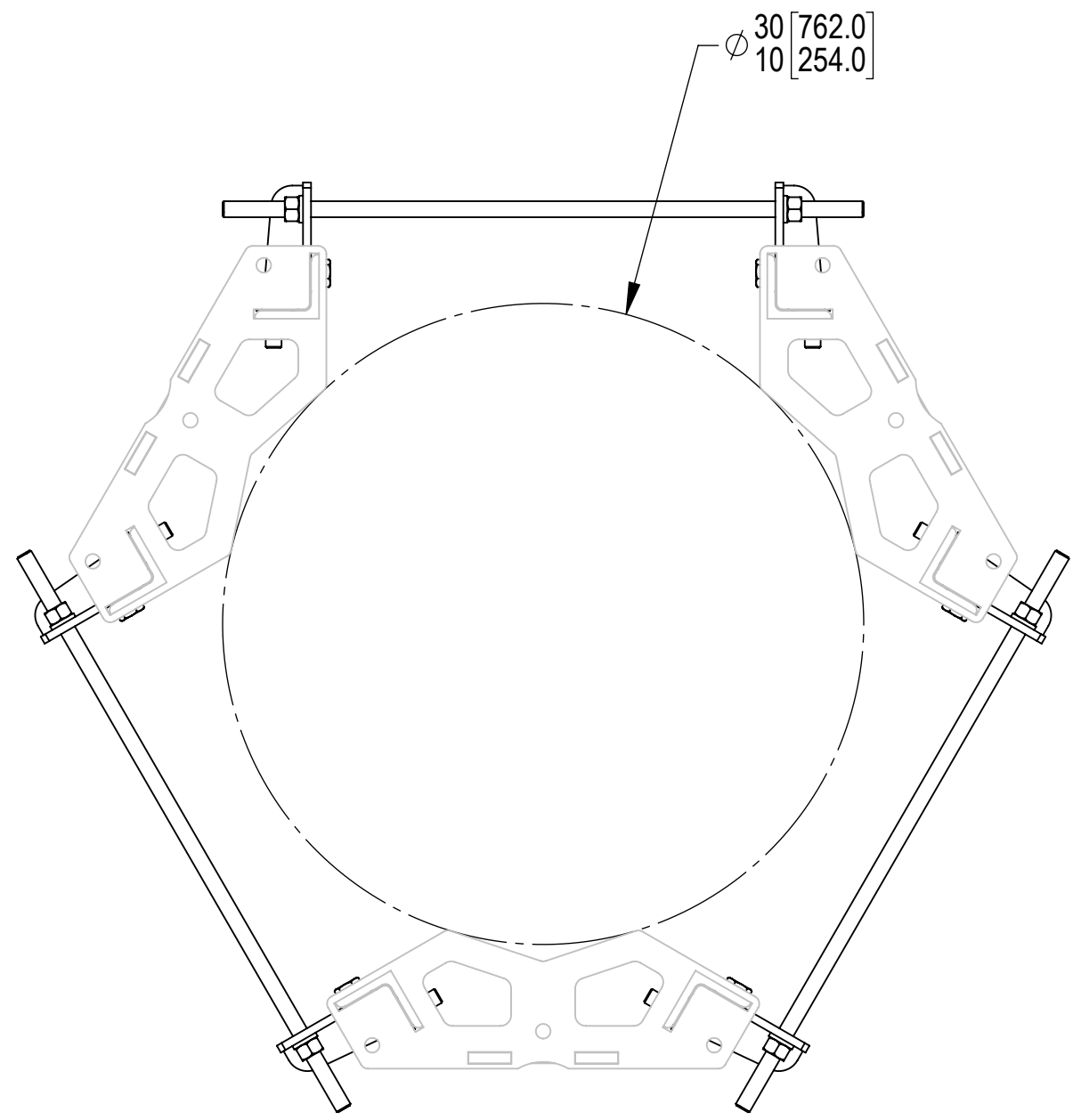

RING MOUNT RM1030-3  
 SUPPLIED SEPARATELY

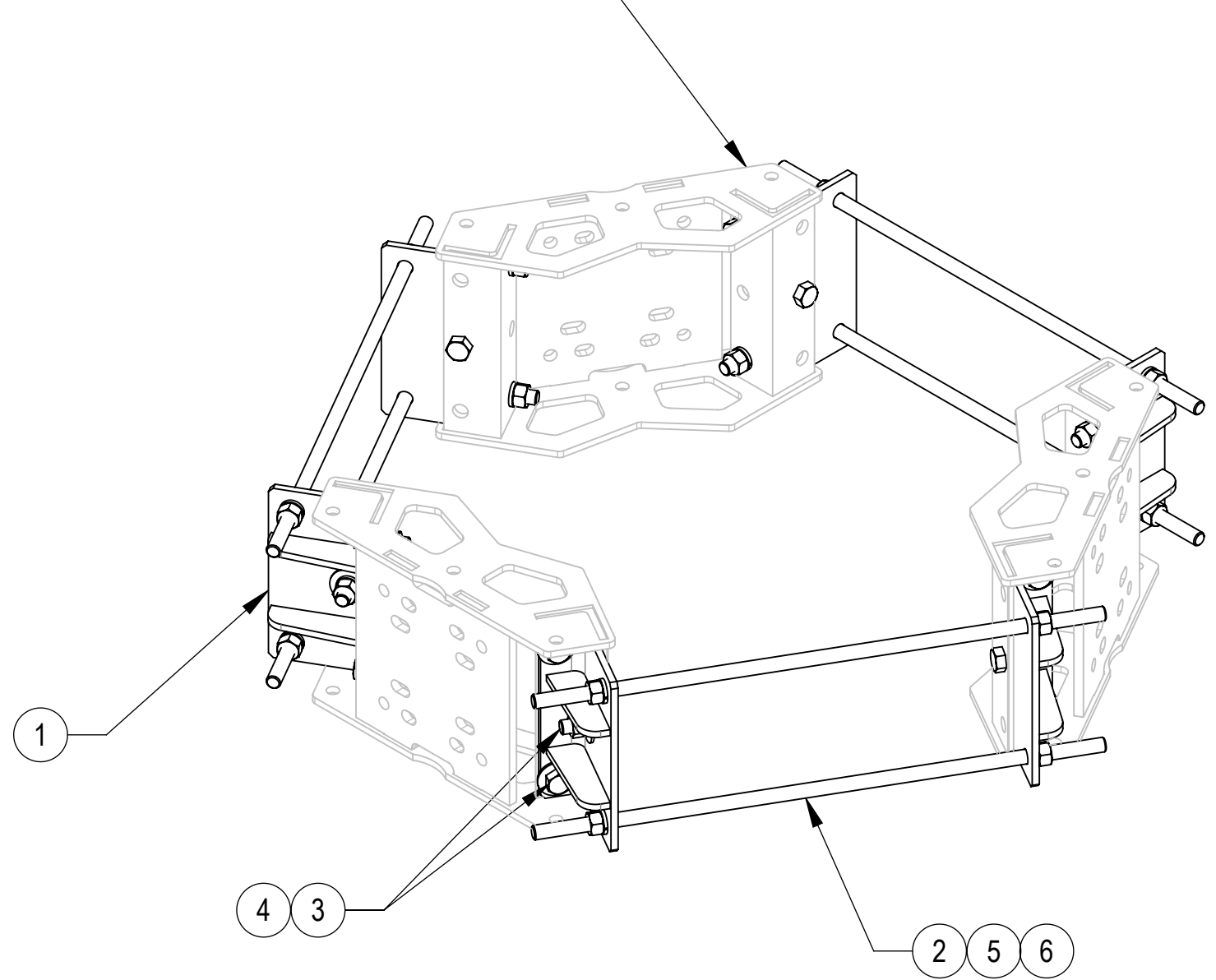

DO NOT REUSE OLD HARDWARE, NEW HARDWARE PROVIDED

COMMSCOPE, INC. OF NORTH CAROLINA				
TITLE EXT PLATE KIT, RING MOUNT				
SIZE <b>C</b>	SCALE <b>1:12</b>	DOCUMENT NO. <b>MC-RM-EXT</b>		
		DRAWING		SHEET
		VERSION	STATUS	REVISION
		00	RE	A
				3 OF 3

© 2024 CommScope, Inc. Confidential

4

3

2

1

